

COMPANY: COX RAYNER
ADDRESS: LEVEL 2, 2 EDWARD STREET
BRISBANE, QLD, 4000

CONTACT: JOHN NEGUS
PHONE: +61 7 3210 0844
FAX: +61 7 3210 0541
WEB: www.cox.com.au

For over 40 years, the Cox practice has maintained a passion for the idea of buildings 'completing' environments. The process of studying closely what already exists in context and of exploring ways to enrich and invigorate, leads to diverse solutions rather than to a particular style or idiom.

The Cox Group of Architects is one of the largest of Australia's national architectural companies. Australian offices are located in Sydney, Brisbane, Melbourne, Perth and Canberra.

International offices are located in Dubai and Abu Dhabi. The Cox Group offers primary services in Architecture, Planning and Urban Design, and Interior Design.

During a decade of sparse development in the office building sector, the Brisbane branch of the Cox Group - Cox Rayner - has designed a wide range of completed and current office projects.

They include new corporate headquarters for major companies, public sector office buildings, speculative office buildings, refurbishments and the largest private sector fitout in Brisbane in the past 10 years. The gross floor area of these buildings exceeds 200,000m².

In addition to these, Cox Rayner has undertaken several large scale office components of other building types including major hospital and law courts.

completing environments

111 eagle street

The 111 Eagle Street tower project was awarded to Cox Rayner after a national design competition.

The design was "head and shoulders above the others" according to Mr. Tony Cope, of clients, the GPT Group. The building will be a \$330 million premium grade office building incorporating a total of 58 levels, rising 200 metres above street level, with views to the Brisbane River and Hinterland.

It will contain more than 63,000 sqm. of commercial space.

Perhaps the most striking aspect of the new tower will be the unusual, organic perimeter "fig-tree" column configuration, consisting of steel tubes filled with concrete, forming a structural web. These columns reflect the remarkable stand of three fig trees in the fig tree reserve immediately opposite the corner of the building.



The tower, designed to be one of the most sustainable office developments in Australia when it is completed in 2011, will contain chilled beams with 100% outside air plus a perimeter hot air exhaust system to pull heat from the facade glazing zone.

The ceiling is 50% perforated metal panels in a 1500mm module to maximise tenant fitout and efficiency. All services are integrated into the ceiling system.

The building incorporates rain harvesting, gray water recycling, provision for black water treatment and harvesting the gray water, power co-generation and river heat rejection.

The facade is a unitised IGU curtain wall system with clear solar control glass, giving maximum protection against the sun, while retaining high light transmission, thus allowing the fig tree structural system to be seen from outside the building as it rises up the building facades.

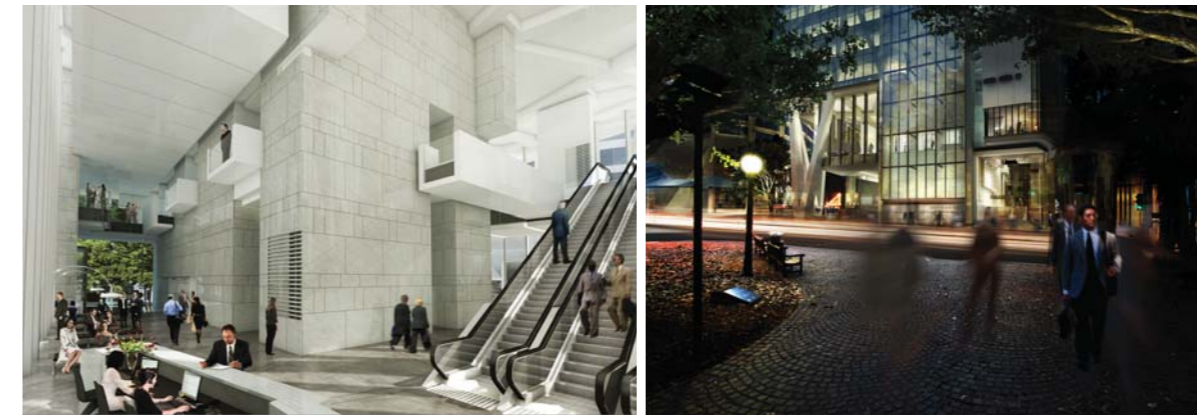

Revit was used as the primary CAD system for the 111 Eagle Street project, spanning through early design phases, to exporting views to Illustrator and 3ds Max for submissions and presentations, culminating in full contract documentation of all trade packages.

The documentation co-ordination features of Revit make it particularly beneficial to our practice where trade package projects are concerned.

Updating of early package documentation during the later phases of construction has always been a problem for architects. Revit completes this task automatically, ensuring that the newly issued documents incorporate all changes and revisions.

KarelCAD have been an invaluable partner to the Cox Group, providing us with ongoing training, support and access to high level contacts within the industry in general and to Autodesk in particular.

