

FAIRWEATHER PROBERTS

COMPANY: Fairweather Proberts Architects
ADDRESS: LEVEL 1, 370 QUEEN STREET
BRISBANE, QLD 4000

CONTACT: JASON HEDGES
PHONE: +61 7 3221 0672
FAX: +61 7 3221 0683
WEB: www.fairweatherproberts.com.au

Fairweather Proberts Architects create buildings and spaces through their involvement in master planning, interior design, commercial, educational and residential projects.

The practice was established in 1996 and has built its reputation for design excellence, open communication with clients and responsiveness in developing and implementing solutions for their projects.

Their commitment to understanding a client's needs and exploring opportunities beyond traditional boundaries is central to how their team work every day.

Their close collaboration with other members of a project team, including engineers, planners and specialist consultants, has consistently resulted in development innovations that best serve a project's end users and wider communities.

kaust beacon saudi arabia

Fairweather Proberts Architects and Urban Art Projects collaborated to provide a landmark beacon for the King Abdullah University of Science and Technology. Fairweather Proberts were also assisted with shop drawing documentation by Cadway Project Documentation Pty Ltd.

The KAUST Beacon represents the distinctive form of the coral of the adjacent Red Sea Reef, morphing to carbon strands symbolic of the University as a place of learning and progress.

Project: KAUST Beacon
Client: King Abdullah University of Science and Technology
Location: KAUST, 120km North of Jeddah, Saudi Arabia
Value: \$60 million



The dramatic structure emerges from the water with a series of precast hexagonal extrusions growing in a gentle sweep to form the organic profile of the beacon.

The interior atrium, dappled in shade and light, is a reverential space designed for communal gatherings. The sixty metre high structure is a focal point for the University, a dramatic ethereal spire, a place for reflection and an icon for the ambitious new development.

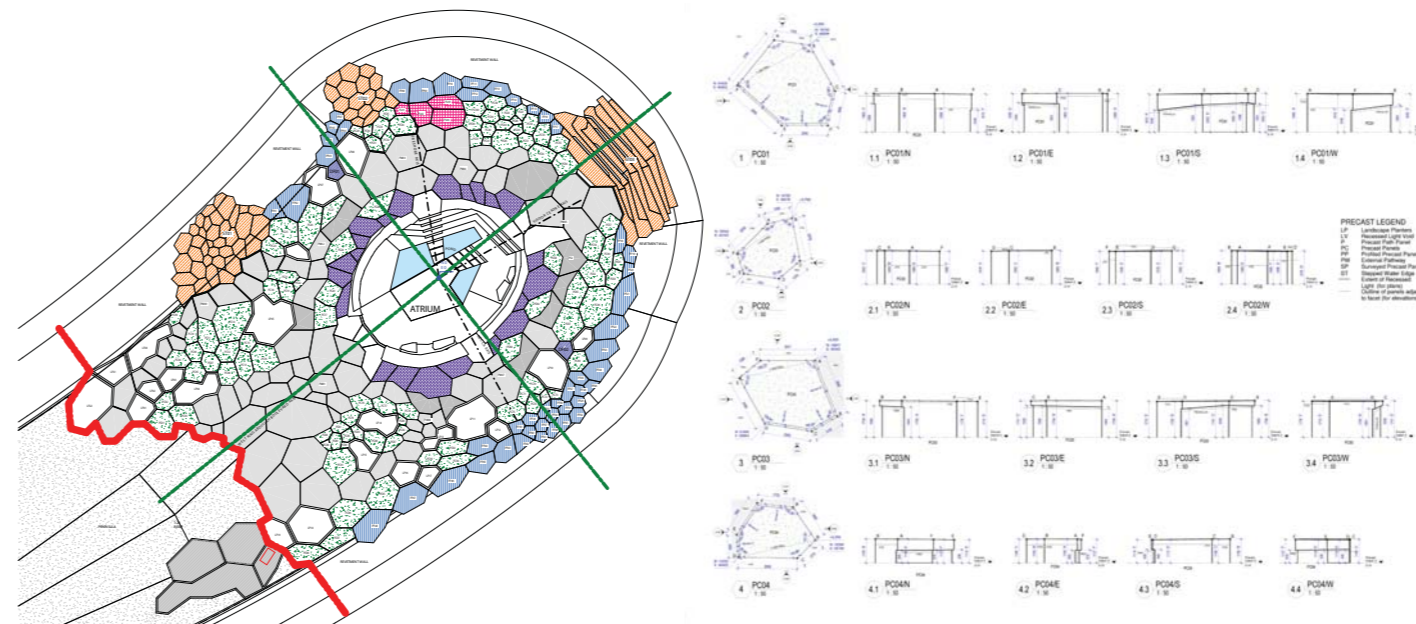

The KAUST Beacon is a complex artistic project requiring a sophisticated 3D visual design tool to aid in the design and documentation process.

Revit provides reliable documentation due to its ability to comprehensively model the complex 3D forms. Revit additionally allows the creation of Parametric family objects for custom controllable irregular forms and the tagging and dimensioning of these items which facilitates consistent documentation across multiple drawings.

By working with coordinates in space for both North/East and Relative Levels, Revit allows the documentation of complex forms. These levels and locations are locked to object corners providing reliable updates through the revision process. This enables flexible shaping of multiple objects simultaneously, whilst maintaining dependable documentation.

The Revit Design platform helps with teamwork and collaboration both within the office and with external consultants, with collaboration on structure with Revit Structure aiding in the sharing and coordination of information.

